

MINIATURE BASIC SWITCHES VS SERIES

Features

- Industry standard design with up to 25 A ratings
- Choose from a variety of levers, terminals
- Variety of operating forces (15g to 400g).
- Long service life of 10,000,000 operations
- RoHS Compliant
- High temperature models available up to +150°C(302°F)
- IP67 version available (VS-W series)
- Available in Positive Opening styles (VP series)

Specifications

Operating Speed	0.01mm to 1m/sec(Plunger models without levers)
Operating Frequency	Mechanical: 600 ops/min;Electrical: 60 ops/min
Service Life	Mechanical: 10,000,000 (operations) Electrical: 500,000 min. (operations)
Rated Current/Voltage	0.1A, 3A, 5A, 11A, 16A 1/2HP 125/250VAC 21,25A 1HP/125VAC 2HP/250VAC
Operating Temperature	Standard: -40°C+85°C(-40°F+185°F) High temperature: up to +150°C(302°F)
Dielectric Strength	1,000 VAC, 50/60 Hz for 1 min between terminals of the same polarity 2,000 VAC, 50/60 Hz for 1 min between current-carrying metal parts and ground, and between each terminal and non-current-carrying metal parts
Insulation Resistance	>100MΩ @500VDC
Contact Resistance	<25mΩ (Initial value)
Degree of Protection	IP00

Selection Guide:

VS -	G								
Current	Actuator	Max. Operating Force	Hinge Position	Terminal Type	Contacts Configuration	Contacts Material	Mounting Hole Dia.		
01 0.1A	none Pin plunger	A 15g	none Far from plunger T Near plunger	A 0.187x0.020 Tab	None 1NO/1NC	None Silver	None 3.1mm		
1 1A	1 Short straight lever	B 25 max		B 0.187x0.020 Spread	1 1NO	K Gold plated	N 2.9mm		
3 3A	2 Straight lever	C 50g max		C 0.250x0.032 Tab	2 1NC				
5 5A	3 Long straight lever	D 75g max		D 0.250x0.032 Spread					
11 11A	4 Simulated roller lever	E 150g max		E Short tab					
16 16A	5 Short metal roller lever	F 225g max		F Vertical bent tab					
21 21A	5P Short plastic roller lever	G 300g max		G Bent tab					
25 25A	6 Metal roller lever	H 400g max		P PCB pin					
	6P Plastic roller lever			H Solder lug					
	7 Simulated roller lever (Long)			S Screw					
	8 Custom lever								

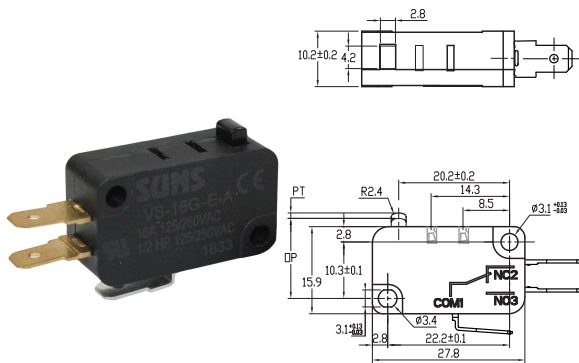

VS-16G/VS-_G Operating Characteristics

Suffix	A	B	C	D	E	F	G	H	OT (Min)	1.27 mm
OF (Max)	15/ 25/ 50/ 75/ 150/ 225/ 300/ 400g								MD (Max)	0.25 mm
PT (Max)	1.19 mm								OP	14.7 ± 0.4 mm

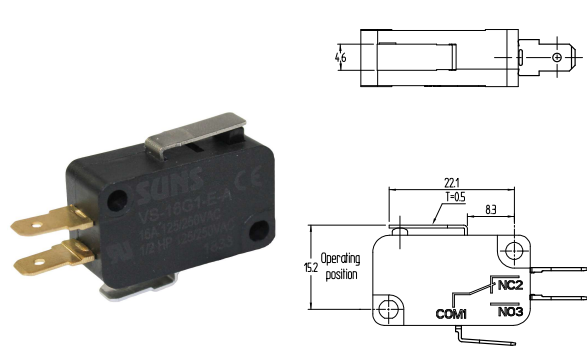

VS-16G1/VS-_G1 Operating Characteristics

Suffix	C	D	E	F	G	H	OT (Min)	1.27 mm
OF (Max)	50/ 75/ 160/ 225/ 300/ 400g						MD (Max)	0.36 mm
PT (Max)	1.52 mm						OP	15.2 ± 0.5 mm

MINIATURE BASIC SWITCHES V SERIES

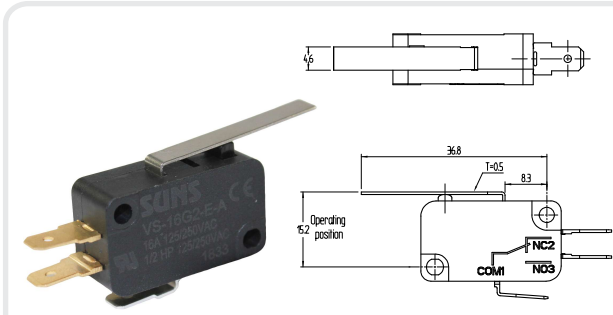

VS-16G2/VS_G2 Operating Characteristics

Suffix	C	D	E	F	G	H	OT (Min)
OF (Max)	30	41	80	130	160	215g	2.2 mm
PT (Max)	3.04 mm						MD (Max) 0.8 mm
							OP 15.2 ± 1.2 mm

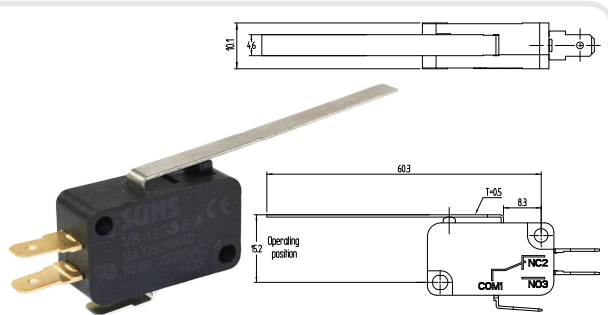

VS-16G3/VS_G3 Operating Characteristics

Suffix	C	D	E	F	G	H	OT (Min)
OF (Max)	16	20	45	69	90	120g	3 mm
PT (Max)	6.0 mm						MD (Max) 2 mm
							OP 15.3 ± 2.6 mm

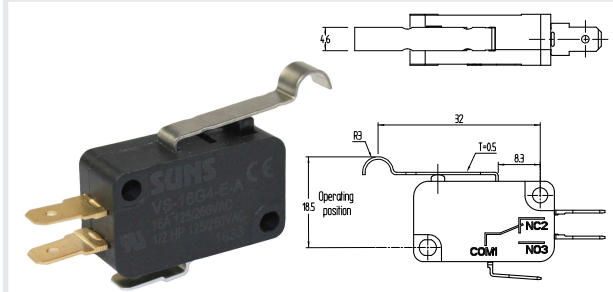

VS-16G4/VS_G4 Operating Characteristics

Suffix	C	D	E	F	G	H	OT (Min)
OF (Max)	35	50	90	140	180	225g	1.55 mm
PT (Max)	2.8 mm						MD (Max) 0.8 mm
							OP 18.5 ± 1.2 mm

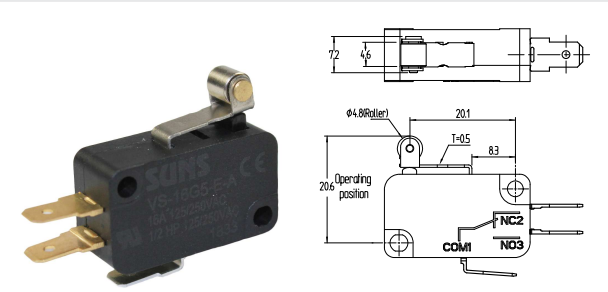

VS-16G5/VS_G5 Operating Characteristics

Suffix	C	D	E	F	G	H	OT (Min)
OF (Max)	50	90	160	283	300	400g	0.86 mm
PT (Max)	1.42 mm						MD (Max) 0.38 mm
							OP 20.5 ± 0.6 mm

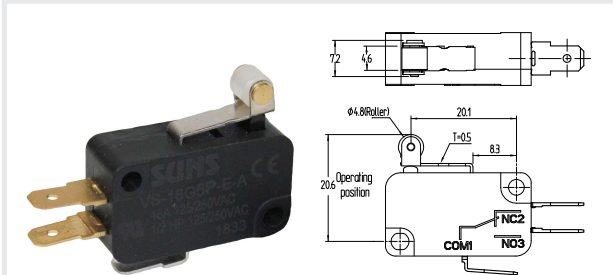

VS-16G5P/VS_G5P Operating Characteristics

Suffix	C	D	E	F	G	H	OT (Min)
OF (Max)	50	90	160	283	300	400g	0.86 mm
PT (Max)	1.42 mm						MD (Max) 0.38 mm
							OP 20.5 ± 0.6 mm

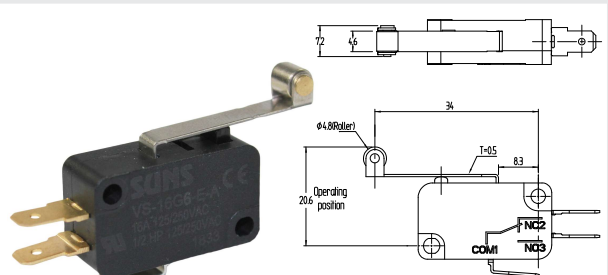

VS-16G6/VS_G6 Operating Characteristics

Suffix	C	D	E	F	G	H	OT (Min)
OF (Max)	35	43	90	140	175	225g	1.52 mm
PT (Max)	3.07 mm						MD (Max) 0.76 mm
							OP 20.5 ± 1.6 mm

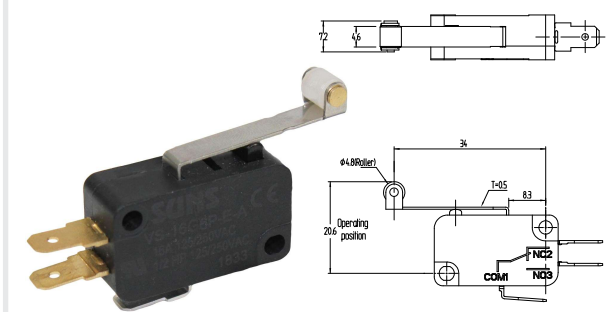

VS-16G6P/VS_G6P Operating Characteristics

Suffix	C	D	E	F	G	H	OT (Min)
OF (Max)	35	43	90	140	175	225g	1.52 mm
PT (Max)	3.07 mm						MD (Max) 0.76 mm
							OP 20.5 ± 1.6 mm

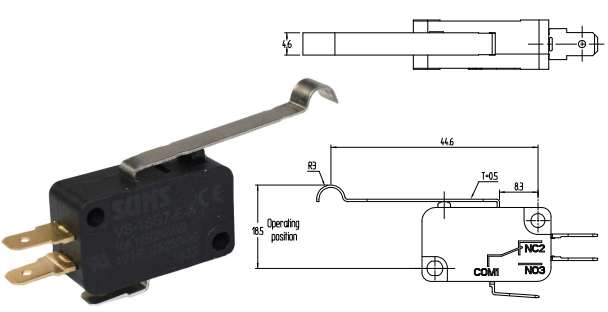

VS-16G7/VS_G7 Operating Characteristics

Suffix	C	D	E	F	G	H	OT (Min)
OF (Max)	25	38	73	120	150	200g	3 mm
PT (Max)	6.0 mm						MD (Max) 2 mm
							OP 20.5 ± 2.0 mm

MINIATURE BASIC SWITCHES VS SERIES

Terminals:

VS Series -A
0.187x0.020 Tab

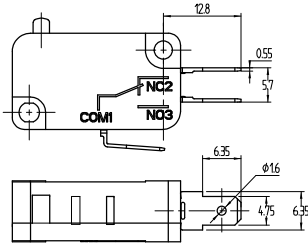

VS Series -B
0.187x0.020 Spread Tab

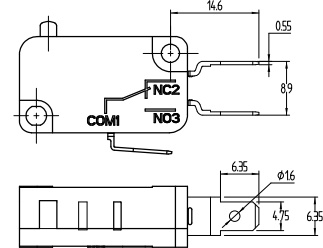

VS Series -C
0.250x0.032 Tab

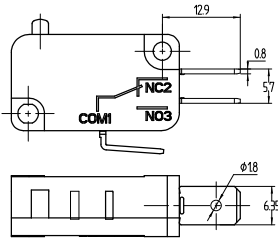

VS Series -D
0.250x0.032 Spread Tab

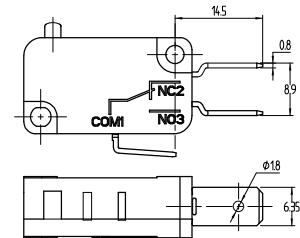

VS Series -E
Short Tab

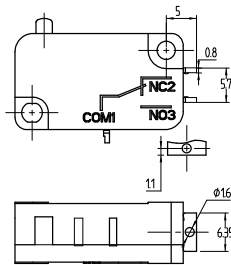

VS Series -F
Vertical Bent Tab

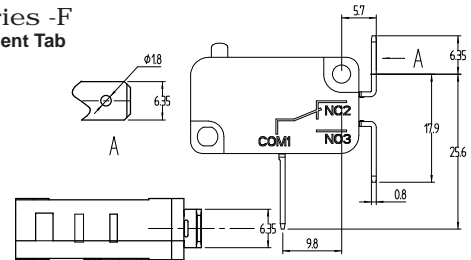

VS Series -G
Bent Tab

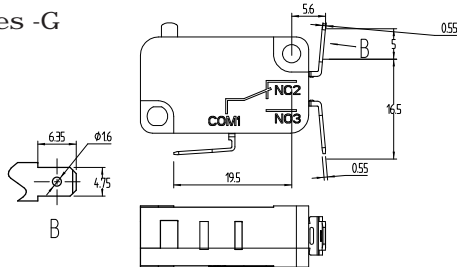

VS Series -H
Soldered Lug

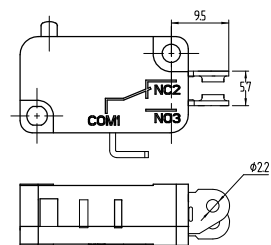

VS Series -S
Screw

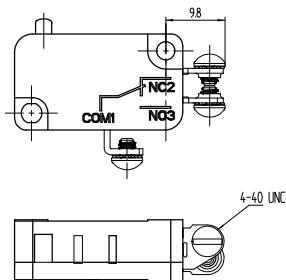

VS Series -P
-PL Left PCB Pin

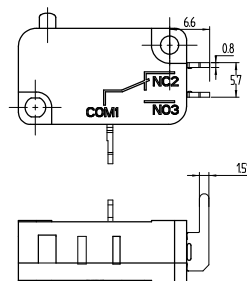

-PR Right PCB Pin

