

SLS-40 Series (Square Type) Inductive Proximity Switches

Housing Type: Plastic
 Operating Temperature: -25**70*
 protection: Reverse Polarity Protection +
 Short circuit and overload protection
 LED indicator: Red output energized,360 visibility
 Degree of Protection: IP67 (EN 60529)
 Applicable Standard: GB/T14048.10 EN 60947-5-2
 Certification: UL Certification: E310408
 CCC Certification: 20080103050268320

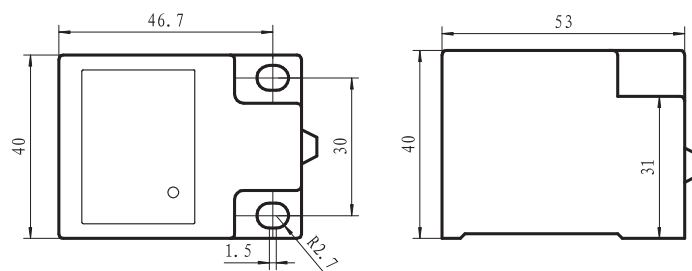

■ Dimensions (mm)



■ Specifications

Type	Model Number(s)	Sn Sensing Rangemm	Type		Rated Voltage			Output					
			Shielded	Unshielded	10-30VDC	10-36VDC	20-250VAC	Normal Open	Normal Close	NPN	PNP	Load Current (Max)mA	Switching Frequency Hz
DC-2 Wire Shielded	SLS-40-15DE0	15	*		*			*				50	300
	SLS-40-15DEC	15	*		*				*			50	300
DC-2 Wire Unshielded	SLS-40-20DNO	20		*	*			*				50	200
	SLS-40-20DNC	20		*	*				*			50	200
DC-3 Wire Shielded	SLS-40-15DEON	15	*			*		*		*		200	300
	SLS-40-15DEOP	15	*			*		*			*	200	300
	SLS-40-15DECN	15	*			*			*	*		200	300
	SLS-40-15DECP	15	*			*			*		*	200	300
DC-3 Wire Unshielded	SLS-40-20DNON	20		*		*		*		*		200	200
	SLS-40-20DNOP	20		*		*		*			*	200	200
	SLS-40-20DN CN	20		*		*			*	*		200	200
	SLS-40-20DNCP	20		*		*			*		*	200	200
AC-2 Wire Shielded	SLS-40-15AEO	15	*				*	*				350	25
	SLS-40-15AEC	15	*				*		*			350	25
AC-2 Wire Unshielded	SLS-40-20ANO	20		*			*	*				350	25
	SLS-40-20ANC	20		*			*		*			350	25